

Medium Capacity Hollow Cone Spray Nozzles

AAP

Hollow Cone

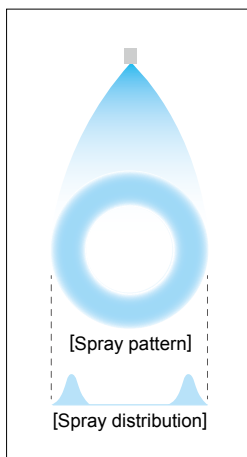
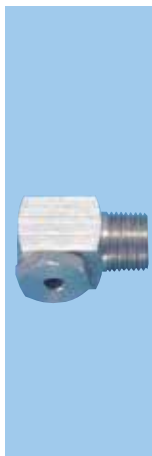

- Hollow cone spray nozzle with relatively fine atomization and stable spray pattern at both low and high pressure.
- No-whirler design minimizes clogging.
- Spraying axis at 90° angle from the nozzle inlet.

[STANDARD PRESSURE]

0.2 MPa

[APPLICATIONS]

Cleaning: Gas, air, machines, pre-paint treatment

Cooling: Gas, air handling unit, roofs, machineries, foods, warm water

Spraying: Aeration, humidification

| | |
|-----------|---|
| Structure | <ul style="list-style-type: none"> • Includes a nozzle body and orifice cap. • Orifice cap is screwed into the nozzle body. |
| Material | <ul style="list-style-type: none"> • Nozzle body: S304 • Orifice cap: S303 <p>SPECIAL ORDER MATERIAL: S316 or S316L</p> |

| Pipe conn. size | Dimensions (mm) | | | | | | Weight (g) |
|-----------------|-----------------|------|------|----|----|------|------------|
| | L1 | L2 | L3 | L4 | W | N | |
| R1/4 | 32 | 23 | 20.5 | 16 | 16 | 10.5 | 49 |
| R3/8 | 36 | 26 | 23.5 | 19 | 19 | 11 | 72 |
| R1/2 | 46 | 33.5 | 31 | 25 | 25 | 14 | 160 |

[Note] Appearance and dimensions may differ slightly depending on material and nozzle code.

DRAWING

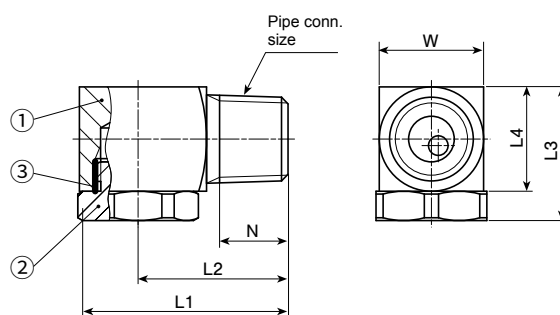

① Nozzle body (S304) ② Orifice cap ③ Adhesive

| Spray capacity code | Pipe conn. size | | | Spray angle (°) | | | Spray capacity (L/min) | | | | | | | | Mean droplet diameter (μm) | Free passage diameter (mm) |
|---------------------|-----------------|------|------|-----------------|---------|---------|------------------------|----------|---------|----------|---------|---------|---------|-----|----------------------------|----------------------------|
| | R1/4 | R3/8 | R1/2 | 0.05 MPa | 0.2 MPa | 0.5 MPa | 0.03 MPa | 0.05 MPa | 0.1 MPa | 0.15 MPa | 0.2 MPa | 0.3 MPa | 0.5 MPa | | | |
| 01 | ○ | | | 71 | 75 | 77 | 0.40 | 0.51 | 0.72 | 0.87 | 1.00 | 1.22 | 1.55 | 260 | 2.0 | |
| 02 | ○ | | | 71 | 75 | 77 | 0.80 | 1.03 | 1.43 | 1.74 | 2.00 | 2.43 | 3.11 | } | 2.5 | |
| 03 | ○ | | | 71 | 75 | 77 | 1.21 | 1.54 | 2.15 | 2.61 | 3.00 | 3.65 | 4.66 | | 3.2 | |
| 04 | ○ | | | 76 | 80 | 82 | 1.61 | 2.05 | 2.87 | 3.48 | 4.00 | 4.86 | 6.21 | | 3.7 | |
| 05 | ○ | | | 76 | 80 | 82 | 2.01 | 2.57 | 3.58 | 4.35 | 5.00 | 6.08 | 7.77 | 500 | 4.2 | |
| 06 | | ○ | | 76 | 80 | 82 | 2.41 | 3.08 | 4.30 | 5.22 | 6.00 | 7.29 | 9.32 | 470 | 4.8 | |
| 07 | | ○ | | 76 | 80 | 82 | 2.81 | 3.59 | 5.02 | 6.10 | 7.00 | 8.51 | 10.9 | } | 5.0 | |
| 08 | | ○ | | 76 | 80 | 82 | 3.21 | 4.11 | 5.73 | 6.97 | 8.00 | 9.72 | 12.4 | | 5.2 | |
| 10 | | ○ | | 76 | 80 | 83 | 4.02 | 5.14 | 7.17 | 8.71 | 10.0 | 12.2 | 15.5 | | 5.4 | |
| 12 | | ○ | | 76 | 80 | 83 | 4.82 | 6.16 | 8.60 | 10.4 | 12.0 | 14.6 | 18.6 | 650 | 5.9 | |
| 14 | | | ○ | 76 | 80 | 83 | 5.62 | 7.19 | 10.0 | 12.2 | 14.0 | 17.0 | 21.7 | 580 | 6.8 | |
| 18 | | | ○ | 76 | 80 | 83 | 7.23 | 9.24 | 12.9 | 15.7 | 18.0 | 21.9 | 28.0 | } | 7.5 | |
| 23 | | | ○ | 76 | 80 | 83 | 9.24 | 11.8 | 16.5 | 20.0 | 23.0 | 28.0 | 35.7 | | 800 | 8.0 |

HOW TO ORDER

To inquire about or order a specific nozzle please refer to this coding system.

Example: 1/4M AAP 01 S303

| | | | |
|-------------------|-----|---------------------|------------|
| 1/4M | AAP | 01 | S303 |
| Pipe conn. size*1 | | Spray capacity code | Material*2 |
| 1/4M | | 01 | |
| 3/8M | | 3 | |
| 1/2M | | 23 | |

*1) "M" indicates male thread ("R" of the ISO standard), e.g. 1/4M = R1/4.

*2) S303 refers to the material of the orifice cap and the nozzle body is S304.