

# High Flow Rate Ejector Nozzles for Solution Agitation

Made-to-Order

**EJX-H**

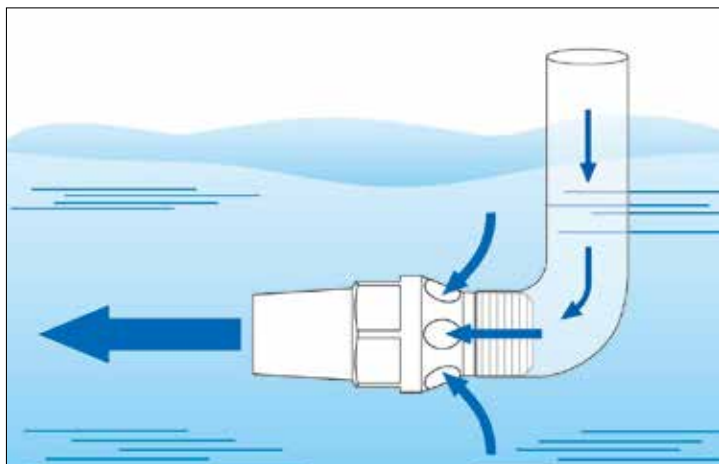

- High flow rate EJX series effectively agitates liquids for cleaning and promoting reactions, featuring 1.5-2 times higher spray impact (flow velocity) compared to the conventional EJX series.

**[STANDARD PRESSURE]**  
0.1 MPa

**[APPLICATIONS]**

- Solution agitation (even mixing, preventing deposition)
- Cleaning in liquids
- Submerged etching and plating

Structure	• One-piece structure, made of plastic.
Material	• PP

Pipe conn. size	Dimensions (mm)				Weight (g)
	L	øD1	øD2	N	
R1/2	110	32	25	14	30
R3/4	160	45	41	15	90

[Note] Appearance and dimensions may differ slightly depending on material and nozzle code.

**DRAWING**

■ 1/4M EJX 1\*0/5.8PP-IN (ø19-50, ø6)

Weight: 5g

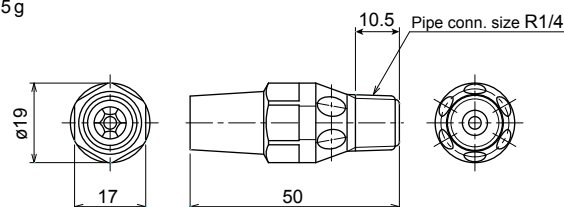

■ 1/2M EJX 1\*0/22PP (ø32-110)

■ 3/4M EJX 1\*0/64PP (ø45-160)

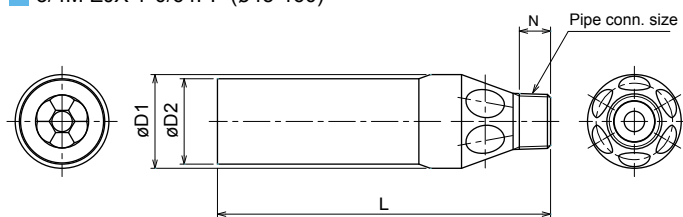

Unit: mm

**SPRAY IMPACT COMPARISON**

■ EJX-H Series (High Flow Rate Type)

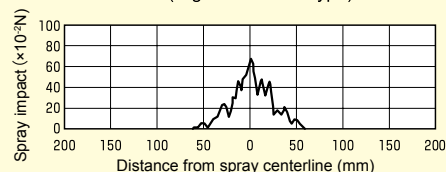

Model: 3/4M EJX 1\*0/64PP (ø45-160)

■ EJX Series (Conventional type)

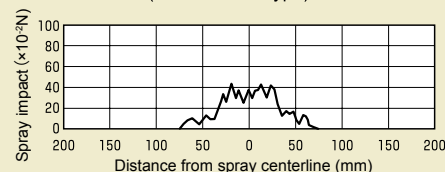

Model: EJX nozzle with the same discharge flow rate as the left-hand EJX-H

■ Measurement conditions

Spray pressure: 0.1 MPa  
Supply flow rate: 64 L/min  
Measurement distance: 300 mm  
Spray impact value: Total spray impact measured by a ø3 mm contact terminal

Product description	Supply flow rate (L/min)						Discharge flow rate (L/min) [Reference only]						Free passage diameter (mm)
	0.03 MPa	0.05 MPa	0.1 MPa	0.15 MPa	0.2 MPa	0.3 MPa	0.03 MPa	0.05 MPa	0.1 MPa	0.15 MPa	0.2 MPa	0.3 MPa	
1/4M EJX 1*0/5.8PP-IN (ø19-50, ø6)	3.20	4.00	5.80	7.10	8.20	10.0	10.5	13.4	18.8	23.2	27.0	34.5	2.8
1/2M EJX 1*0/22PP (ø32-110)	12.0	16.0	22.0	27.5	32.0	39.0	36.0	47.0	73.0	95.0	111	134	5.5
3/4M EJX 1*0/64PP (ø45-160)	36.0	46.0	64.0	77.0	90.6	109	103	140	206	260	301	380	9.1

**HOW TO ORDER**

Please use these product codes for inquiries and orders.

- 1/4M EJX 1\*0/5.8PP-IN (ø19-50, ø6)
- 1/2M EJX 1\*0/22PP (ø32-110)
- 3/4M EJX 1\*0/64PP (ø45-160)

"M" in the nozzle description indicates male thread ("R" of the ISO standard), e.g. 1/4M = R1/4.

This nozzle series is made-to-order.