

RJ2-PON SERIES / Pressure-open Nozzle with Self-retracting Tip

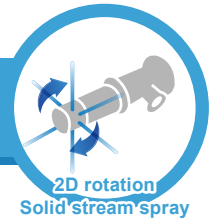

▼ Watch rotating & spraying nozzle on YouTube



IKEUCHI RJ2-PON

Duct cleaning

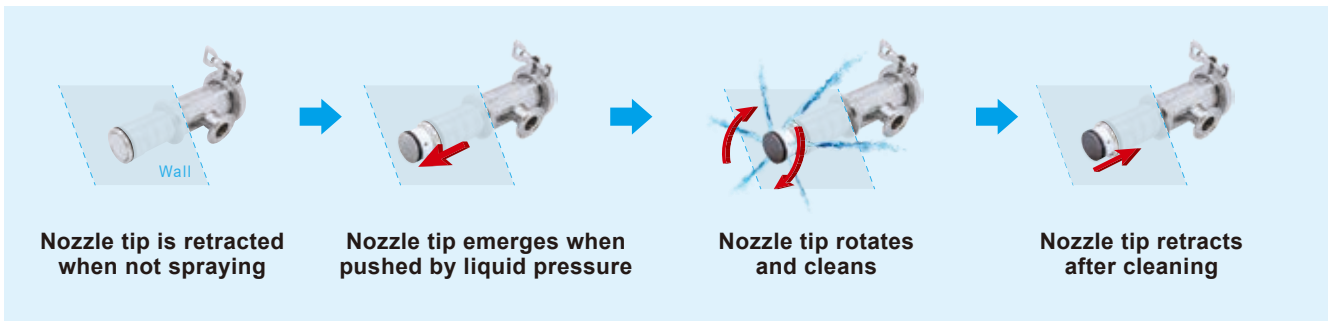

Features

- Pressurized liquid pushes this unique nozzle tip open and it automatically retracts when the liquid pressure stops.
- Powerfully cleans the inside of ducts and tanks.
- Suitable for permanent installation as the nozzle closes flush with the inside surface of the duct or tank when not cleaning.
- Easy to install and remove with ferrule.
- No external power is needed as rotation is driven solely by the flow of the cleaning liquid.

Applications

- Duct cleaning
- Tank cleaning

Basic Specifications

Operating Pressure Range
0.2–0.5 MPa (30–70 psi)

Spray Capacity^{*1}
RJ2-PON30: 24.8–37.6 L/min
RJ2-PON40: 33.1–50.2 L/min
RJ2-PON60: 49.7–75.3 L/min
RJ2-PON80: 66.3–100.4 L/min

Reach Distance of Spray (L)
3,500–5,000 mm

Spreading Angle (θ)
50°

Spreading Width (W)
1,600–2,500 mm

Max. Temperature
80°C (176°F)

Material^{*2, *3}
S304, PTFE, FKM, silicon rubber

Weight
RJ2-PON30: 0.75 kg
RJ2-PON40/60/80: 1.3 kg

Rotation Speed (Target value for reference only)
RJ2-PON30: About 250 rpm
RJ2-PON40/60/80: About 170 rpm

Chemical Resistance
Weak acid/alkaline 3% or less

Spray Coverage

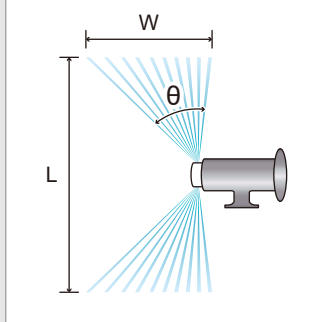

^{*1} Spray flow rate in the above operating pressure range is for reference only. See the flow-rate diagram and chart for more details.

^{*2} In the material code, "S" represents "stainless steel".

^{*3} See the table in the drawing section on page 38.

RJ2-PON SERIES / Pressure-open Nozzle with Self-retracting Tip

Example of Use

Duct Cleaning

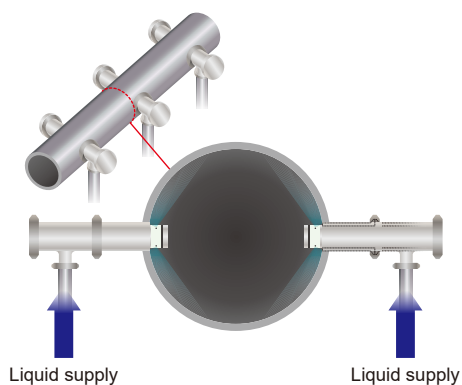

Tank Cleaning

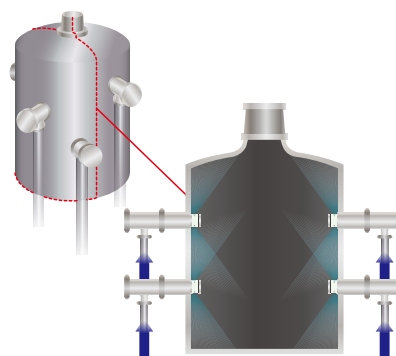

Note: Image shows RJ2-PON nozzles with nozzle tips opened by pressurized cleaning liquid.

Flow-rate Diagram

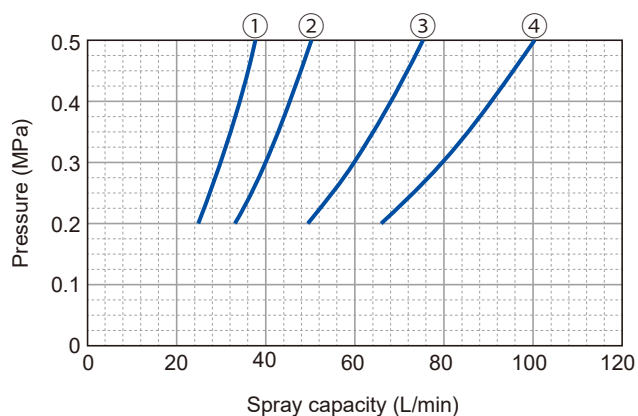

- ① RJ2-PON 30
- ② RJ2-PON 40
- ③ RJ2-PON 60
- ④ RJ2-PON 80

Flow-rate Chart

Spray capacity code	Spray capacity (L/min) [for reference only]						
	0.2 MPa	0.25 MPa	0.3 MPa	0.35 MPa	0.4 MPa	0.45 MPa	0.5 MPa
30	24.8	27.6	30.0	32.1	34.1	35.9	37.6
40	33.1	36.7	40.0	42.8	45.5	47.9	50.2
60	49.7	55.1	60.0	64.3	68.2	71.8	75.3
80	66.3	73.5	80.0	85.7	90.9	95.8	100.4

RJ2-PON SERIES / Pressure-open Nozzle with Self-retracting Tip

Drawing

RJ2-PON30

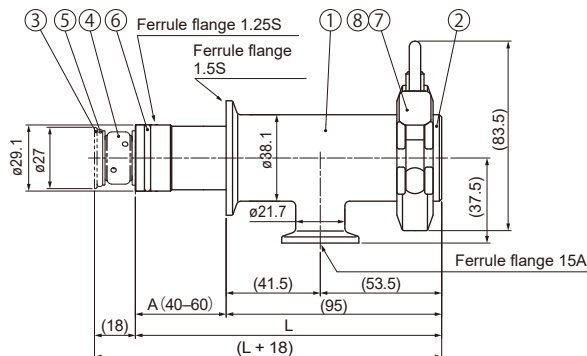
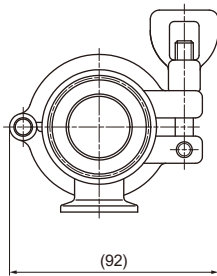

	Components	Material ²
①	Nozzle body	S304
②	Ferrule cap (1.5S)	S304
③	Shaft	S304
④	Nozzle tip (rotating part)	PTFE
⑤	O-ring (P20)	FKM
⑥	O-ring (S26)	FKM
⑦	Ferrule gasket (1.5S)	Silicon rubber
⑧	Clamp (CP2K 1.5S)	S304 equiv.

RJ2-PON40 RJ2-PON60 RJ2-PON80

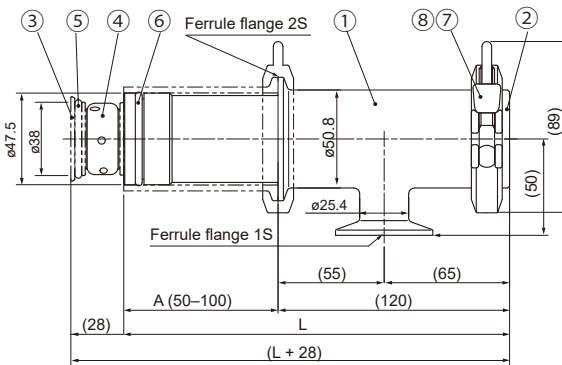
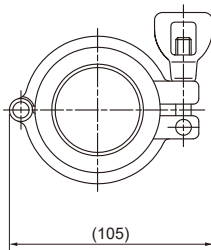

	Components	Material ²
①	Nozzle body	S304
②	Ferrule cap (2S)	S304
③	Shaft	S304
④	Nozzle tip (rotating part)	PTFE
⑤	O-ring (P32)	FKM
⑥	O-ring (P41)	FKM
⑦	Ferrule gasket (2S)	Silicon rubber
⑧	Clamp (CP2K 2S)	S304 equiv.

Note: Short pipe, ferrule flange and clamp which are required for the installation in a tank are to be supplied by customer.

Unit: mm

Comparison of Spray Impact

Measuring Conditions

Measuring method	Pressure indicating film ⁴
Distance from nozzle orifice to film	600 mm
Type of pressure indicating film	5LW (ultra extreme low pressure)
Spray pressure	0.3 MPa

⁴A pressure-sensitive sensor film that quickly reveals surface contact distribution and magnitude of pressure on its entire surface. Red patches appear on the film and the color density indicated varies according to the differing contact pressure levels.

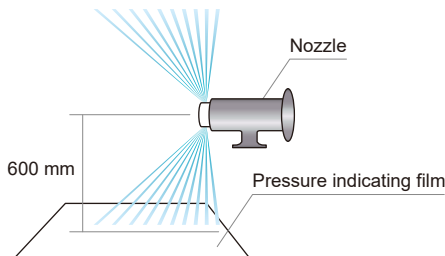

Measurement Results

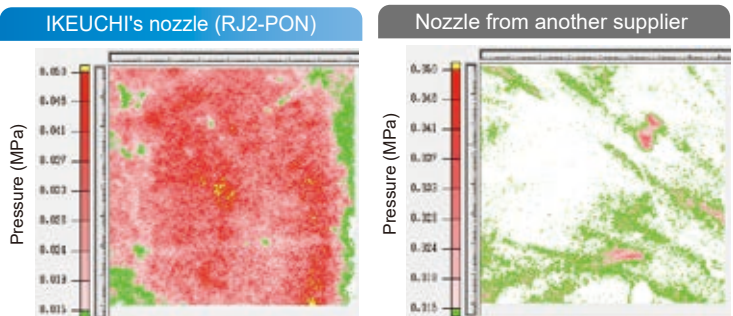

IKEUCHI's RJ2-PON series provides **higher pressure over the entire surface** by rotating at low speed, resulting in **greater cleaning power!**

HOW TO ORDER

To inquire about or order a specific product please refer to this coding system.

Example: RJ2-PON 80-1S × 80 S304

RJ2-PON 80 - 1S × 80 S304

Spray Capacity Code

■30¹⁶ ■40
■60 ■80

Inlet Size

■15A¹⁶
■1S

Insertion Length (A)¹⁵

■40-60¹⁶
■50-100

¹⁵ See dimension A in drawing.

¹⁶ For RJ2-PON30, the inlet size is 15A, and the insertion length A should be within the range of 40-60 mm.